

# CERTA-LOK™ YELOMINE™

## Restrained Joint PVC Pressure Piping System

Certa-Lok™ Yelomine™ is a restrained joint PVC pressure piping system featuring high-impact strength and ultraviolet protection. When designing a piping system or selecting a piping system to meet specific demands, many factors must be taken into consideration — size, flow rate, strength, longevity, load, exposure, impact, chemical resistance, ease of assembly, initial cost, installed cost, quality, etc. This fact sheet has been designed to assist our International Engineering Customers by converting U.S. Dimensions and Specifications to metric measurements.

### COUPLINGS & HYDRAULIC SPECIFICATIONS & DIMENSIONS, CONVERTED TO METRIC MEASUREMENTS

#### CERTA-LOK YELOMINE PIPE

Size (in./mm)	Bar	SDR	OD, (mm)	BOD, (mm)	L2, (mm)	P (mm)	C (mm)	Min. Wall	Weight Kilograms/Meter	Non Permanent Use/Part #	Permanent Use Part #
2"/50mm	18	17	60	81	133	3.18	44.45	3.56	1.03	21625	09225
3"/75mm	18	17	89	111	184	3.18	63.50	5.23	2.22	21725	09325
4"/100mm	14	21	114	139	210	3.18	76.20	5.44	3.04	22625	08425
4"/100mm	18	17	114	139	210	3.18	76.20	6.73	3.50	21825	09425
4"/100mm	22	13.5	114	151	210	3.18	76.20	8.56	4.63	25025	06225
6"/150mm	9	32.5	168	199	210	4.76	76.20	5.18	4.15	24325	06625
6"/150mm	11	26	168	199	210	4.76	76.20	6.48	5.33	23525	07625
6"/150mm	14	21	168	199	210	4.76	76.20	8.03	6.44	22725	08625
6"/150mm	18	17	168	199	210	4.76	76.20	9.91	7.73	21925	09625
6"/150mm	22	13.5	168	212	210	4.76	76.20	12.47	9.85	25125	06325
8"/200mm	7	41	219	259	241	15.88	80.26	5.33	6.10	24125	06425
8"/200mm	9	32.5	219	259	241	15.88	80.26	6.73	7.44	24425	06725
8"/200mm	11	26	219	259	241	15.88	80.26	8.43	9.05	23625	07725
8"/200mm	14	21	219	259	241	15.88	80.26	10.41	10.82	22825	08725
8"/200mm	18	17	219	278	241	15.88	80.26	12.90	13.09	22025	09725
8"/200mm	22	13.5	219	278	241	15.88	80.26	19.00	14.52	23725	06125
10"/250mm	7	41	273	316	305	15.88	88.90	6.65	8.99	24025	09525
10"/250mm	9	32.5	273	316	305	15.88	88.90	8.41	11.50	24525	06825
10"/250mm	11	26	273	316	305	15.88	88.90	10.49	13.54	21425	07825
10"/250mm**	14*	21	273	316	305	15.88	88.90	12.98	16.44	23025	08825
12"/300mm	7	41	324	372	305	15.88	88.90	7.90	11.40	24225	09825
12"/300mm	9	32.5	324	372	305	15.88	88.90	9.96	15.80	24625	06925
12"/300mm	11	26	324	372	305	15.88	88.90	12.45	18.98	21525	07925
12"/300mm**	14*	21	324	372	305	15.88	88.90	15.39	22.88	23925	08925
14"/350mm	11	26	356	406	305	15.88	88.90	13.67	24.18	24725	09925
16"/400mm	7	26	406	442	305	15.88	88.90	15.62	30.53	24825	09025

Note: All dimensions are subject to manufacturing tolerances.

\* PSI on these items is limited by the pressure rating of the coupling

\*\*These heavy wall products are used in special applications where additional safety factor or structural strength is required. For additional information on availability or application, contact your CertainTeed representative.

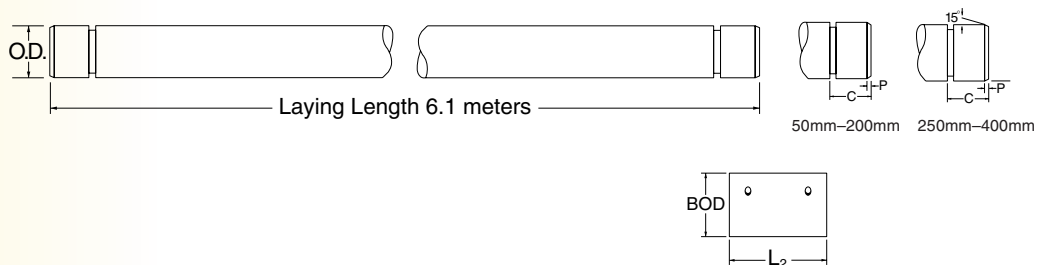

# CERTA-LOK™ YELOMINE™

## Restrained Joint PVC Pressure Piping System

### COUPLINGS

Size mm	Bar	Wt./PC Kilo.	Non Perm. Use/Part #	Perm. Use Part #
2"/50mm	17	0.48	70502	71502
3"/75mm	17	0.98	70503	71503
4"/100mm	17	1.56	70504	71504
4"/100mm-HP	24	2.77	74503	74523
6"/150mm	17	2.81	70506	71506
6"/150mm-HP	24	4.72	74504	74524
8"/200mm	14	4.96	70507	71507
8"/200mm-HP	24	9.07	74505	74525
10"/250mm	11	5.44	70510	71510
12"/300mm	11	7.82	70511	71511
14"/350mm	11	13.61	74501	74521
16"/400mm	6	18.14	74502	74522

### FLOW CHARACTERISTICS

Size (in./mm)	BAR	SDR	Max. ID. (mm)	Flow Liters per Second	Friction Loss Meters Per 1,000 Meters
2"/60mm	18	17	53.24	3.4	13.075
3"/75mm	18	17	78.44	7.1	9.144
4"/100mm	14	21	103.40	12.8	6.029
4"/100mm	18	17	100.84	12.2	6.208
4"/100mm	22	13.5	97.18	11.3	6.527
6"/150mm	9	32.5	157.91	29.9	3.681
6"/150mm	11	26	155.32	28.9	3.753
6"/150mm	14	21	152.25	27.8	3.841
6"/150mm	18	17	148.49	26.4	3.955
6"/150mm	22	13.5	143.33	24.6	4.156
8"/200mm	7	41	208.41	53.6	2.591
8"/200mm	9	32.5	205.59	50.7	2.707
8"/200mm	11	26	202.23	49.0	2.759
8"/200mm	14	21	198.22	47.1	2.825
8"/200mm	18	17	193.27	42.6	2.896
8"/200mm	22	13.5	181.08	41.7	3.059
10"/250mm	7	41	259.74	80.9	2.061
10"/250mm	9	32.5	256.24	78.7	2.094
10"/250mm	11	26	252.04	76.2	2.135
10"/250mm	14	21	247.09	74.4	2.286
12"/300mm	7	41	308.05	113.8	1.690
12"/300mm	9	32.5	303.91	110.7	1.716
12"/300mm	11	26	298.93	107.1	1.737
12"/300mm	14	21	293.07	105.3	1.768
14"/350mm	11	26	328.27	118.0	1.654
16"/400mm	6	26	375.13	168.7	1.343

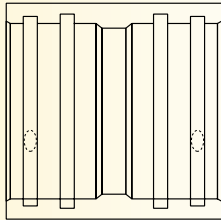
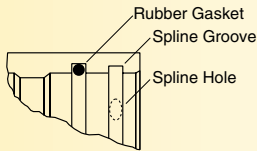

Flow rate and head loss calculated at a velocity of 1.52 meters per second.